



REFRIGERA INDUSTRIALE



Two production Sites:



One Manufacturing Plant based in Cordenons near Pordenone, specialized on **Refrigeration Valves**



One Assembly Plant based in Leinì near Turin, specialized on air conditioning products (copper pipes joint kits and headers for VRF air conditioning systems)

Annual Revenues: € 11,20M (2020 Actual)

Production Plant : 5000sm

Production volume: 305.000 valves/year

Employes: 41 People

R & D (Investmentes): 3% Year Turnover

Sales on 43 Markets

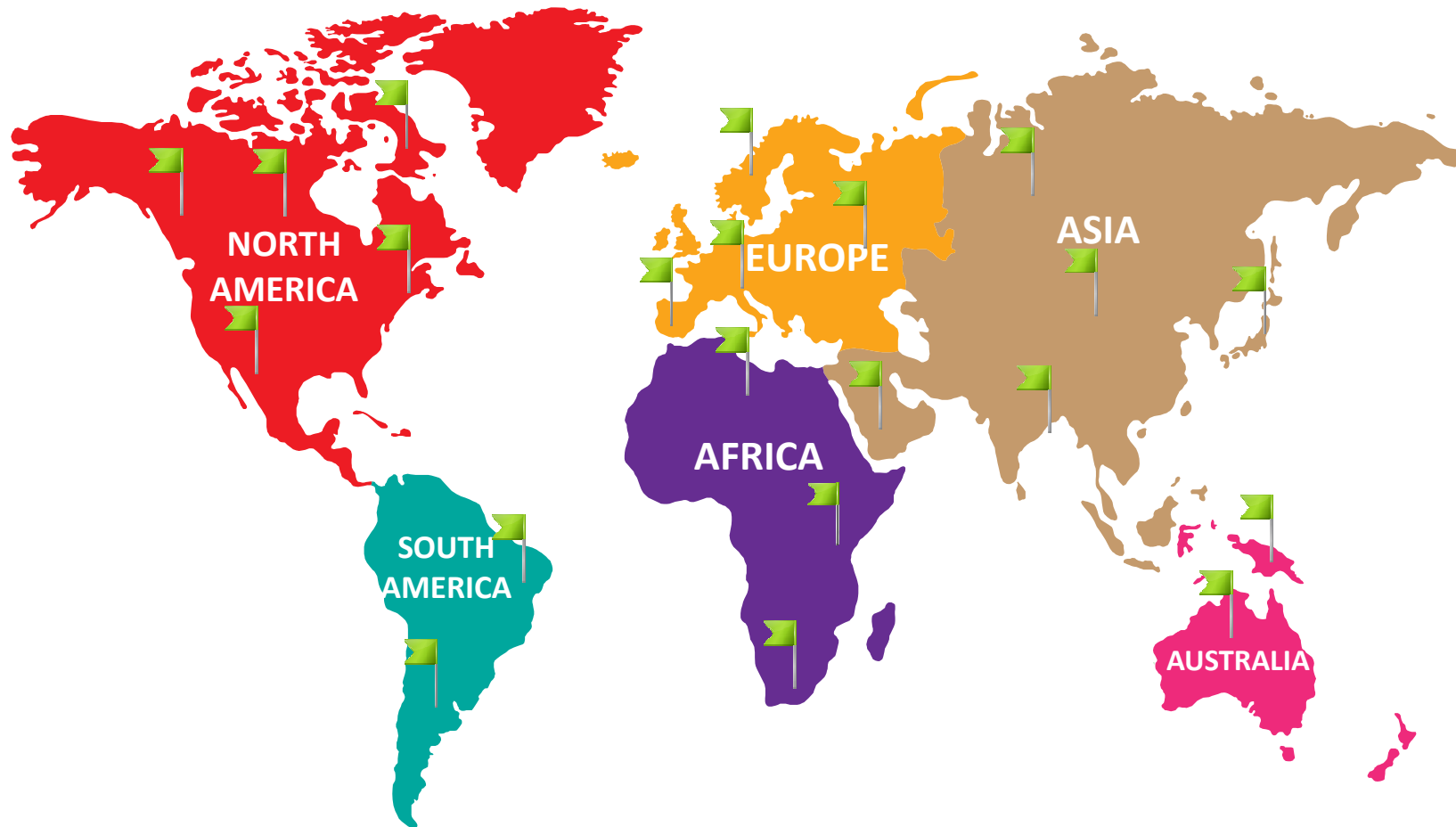

Our way of thinking



High standards of quality:

Refrigera is committed to providing high-quality standards products, which have acquired international certifications from accredited bodies and laboratories. Our quality is made of high-skills welders and workers and of a severe selection of raw material suppliers. Tests and pre-delivery inspections are carried out on every single product



Corporate Environmental Responsibility:

We all in Refrigera have clear that Corporate Environmental Responsibility is a factor that increases competitiveness. Taking into account that all HFCs are very powerful greenhouse gases and have a global warming potential between 1000 and 4000 times higher than CO₂, we have developed a full range of valves suitable for Natural Refrigerants (CO₂, both in subcritical and in transcritical cycle, Hydrocarbon Refrigerants and Ammonia). Behind our brand *REFRIGERA 4 environment* there's our strategy for a continuous innovation of product to enhance the performance and the energy efficiency of our valves.

Our way of thinking



Delivery reliability:

We guarantee accurate and personalized packaging and transport services and the respect of the delivery schedules



Customized products:

Customized products are designed by Refrigera's engineers upon customer's specifications and drawings, both for refrigeration air conditioning systems.

CERTIFICATIONS

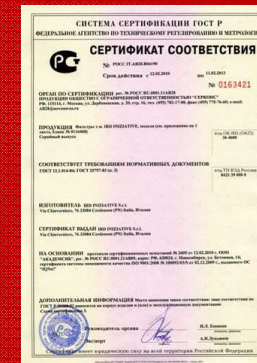

The Refrigerera valves are approved and comply with the main European Legislation:

- ISO 9001:2008
- 2014/68/EU (PED)
- EAC
- ATEX
- UL

It's the owner of Refrigerera® Trade Mark

Automation

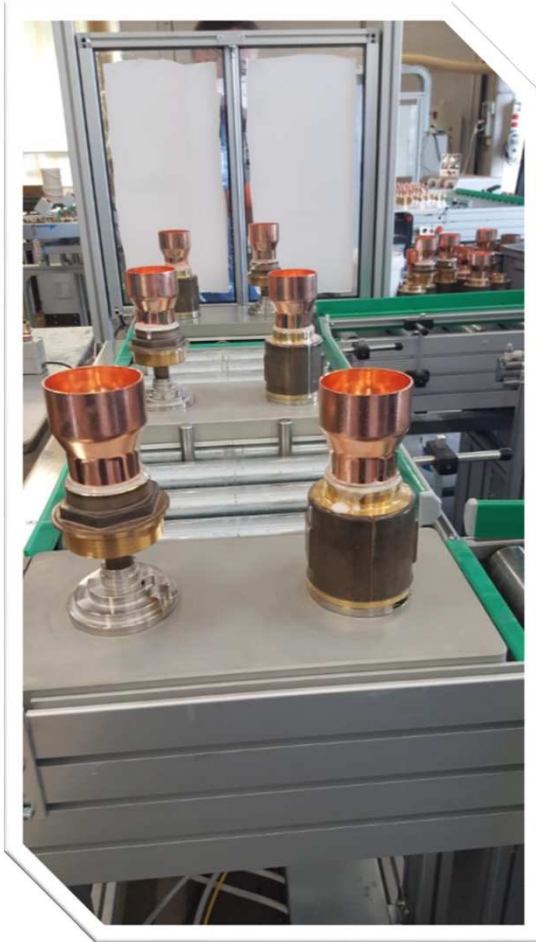

Refriger Industriale S.r.l.
www.Refriger.eu

PRODUCTS RANGE

HFC HFO HC



BALL VALVE
2 – 3 – 4 WAY



FILTERS



MOTORIZED VALVE
2 – 3 – 4 WAY



3 WAY CHANGE OVER



CHECK VALVES



ROTALOCK & ADAPTERS

PRODUCTS RANGE

R744 – CO₂



SUBCRITICAL 60 bar - TRANSCRITICAL 140 bar



**BALL VALVE
SS / K65**



SIGHT GLASSES SS/ K65



**CHECK VALVE
Inox / K65**



Y Strainers



**Motorized Valves
2 – 3 – 4 WAY**



3 WAY CHANGE OVER



FILTERS



ROTALOCK & ADAPTERS

MAIN FEATURES

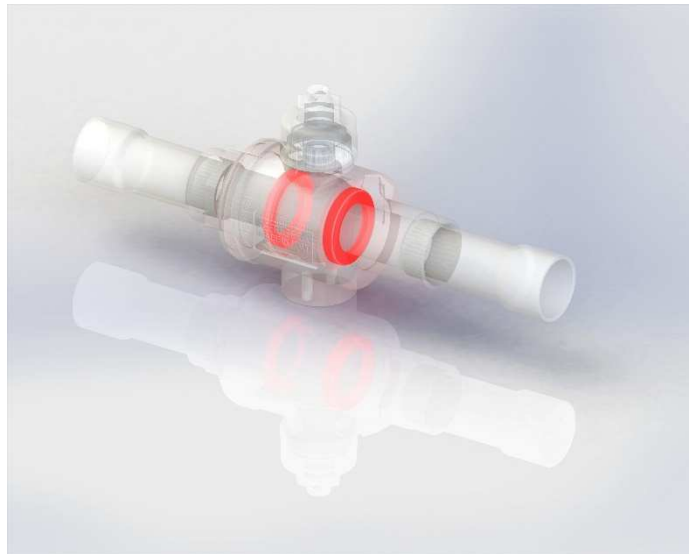

- Internal Seats designed to resist at high pressure are made by an alloy of different materials to allow a long life and a perfect internal seal from side to side.



- Double O-Ring in the valve spindle to avoid leakages from the inside to the outside.
- Different O-Rings are used based on the Fluid Type.

MAIN FEATURES



- FULL BORE passage granted for each size in order to :
 - Guarantee High Kv Values
 - Optimize the Energy Efficiency of the System

•BALL Rotation: Low torque values are obtained with special Internal Balls, shaped and machined in order to have an incredibly smooth surface.



MAIN FEATURES



- The connections are brazed to the valve body using welding rings made by a welding alloy with 45-55% of Silver.

MAIN FEATURES

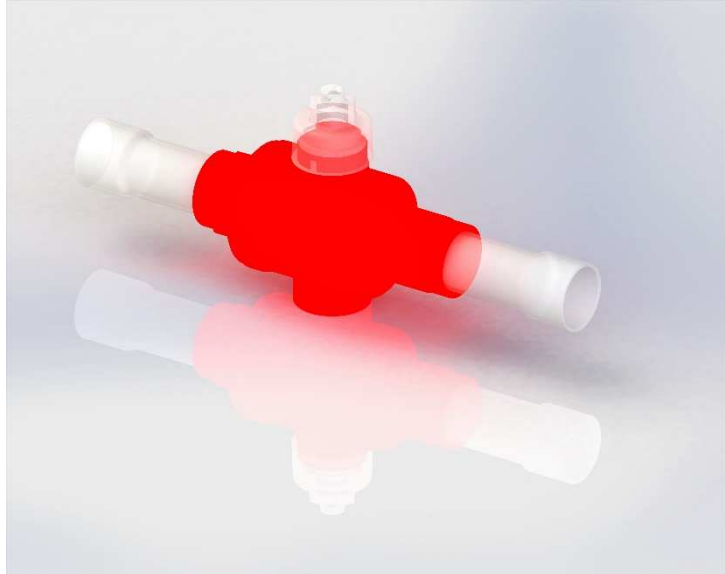

The Raw Materials have been selected from accredited suppliers (Made in Europe)

Incoming Raw materials are examined to prove the compliance.

Burst Test are made in house and/or externally from accredited Third Body Laboratory.

Every single valve is tested before being sold.



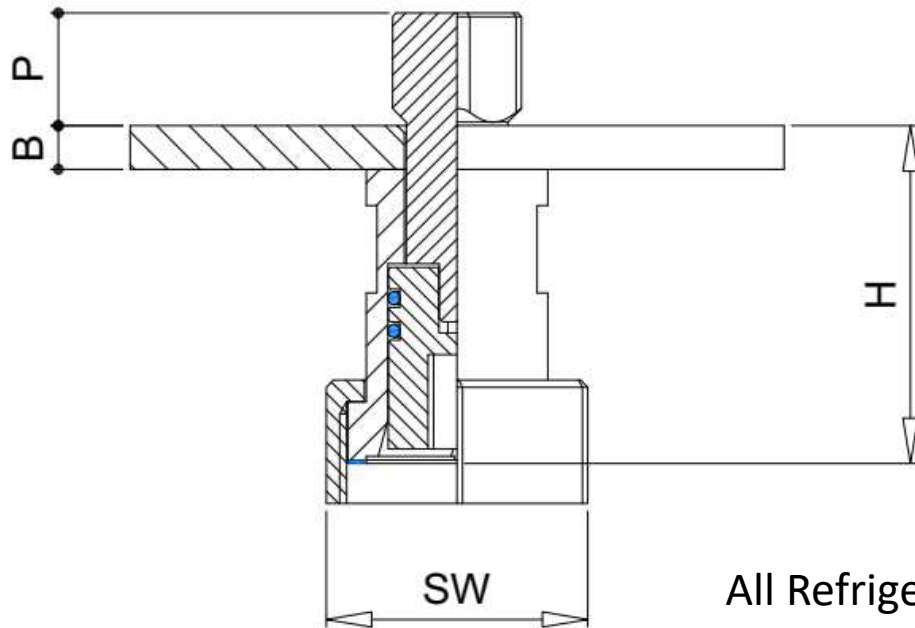

All Refrigera valves are suitable for actuators. The Connection Kit can be mounted easily on the Valve and connected to the actuator through an ISO 5211 – DIN 3337 Flange (F03 F05 F07)

The Connection Kits hold an internal sealing device that lets it to be **Hermetically Sealed** .

This seal technology system ensures the **Tightness Level B1 according to ISO 14903**

TEST PHASE



before being sold

All the Valves are tested



BRASS VALVE Upgrade to 140BAR



New Design = Better Performance



- Higher working pressure 140BAR to perform efficiently in warmer Climates.
- New Internal Seats and O-Rings to extend the valve's life.
- Size available from: 1/4" to 1-3/8"

Wide Range of Schrader Port



New Design = Better Performance



SCHRADER PORT:

- From Size 1/4" up to 1-1/8" (52-140BAR)
- Position in the Valve Body
- Schrader Port bended 45° to optimize the connections of the service Devices

CUSTOMIZATION



Access/Service valves

ODS or BUT WELD + 1/4 SAE M



ODS or BUT WELD + 3/8 GAS F



ODS or BUT WELD + NPT - GAS - SAE - M/F

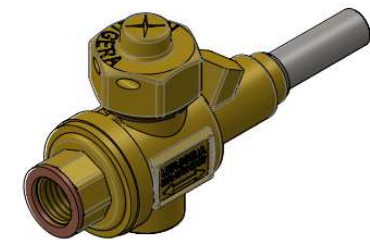

NEW ACCESS VALVE



Directly Connected to the Schrader Port of the Ball Valve

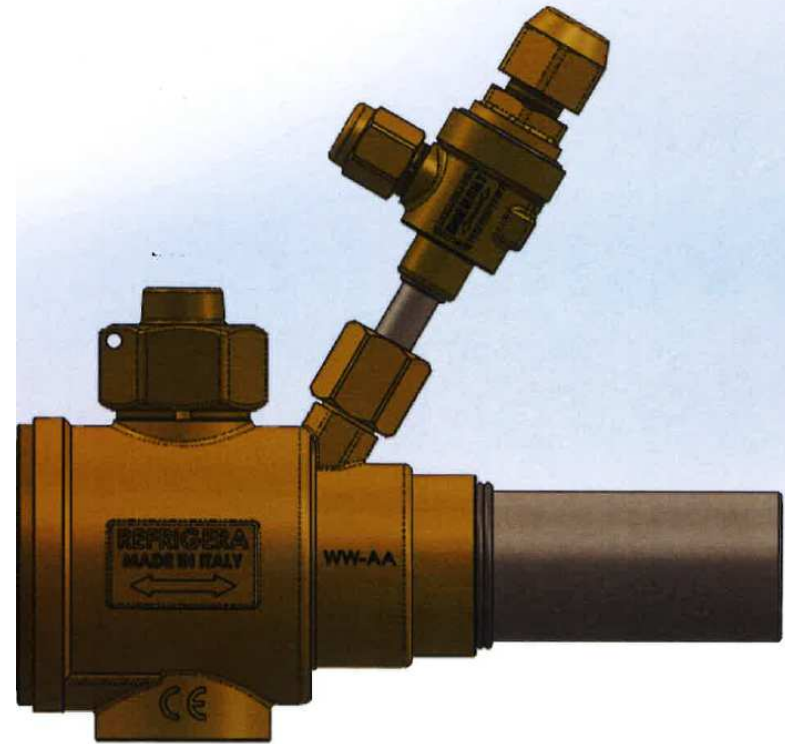
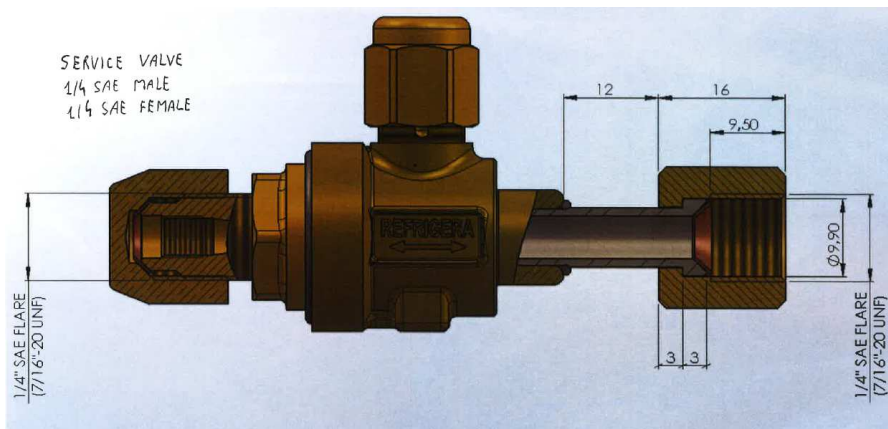

CUSTOMIZATION



Access/Service valves

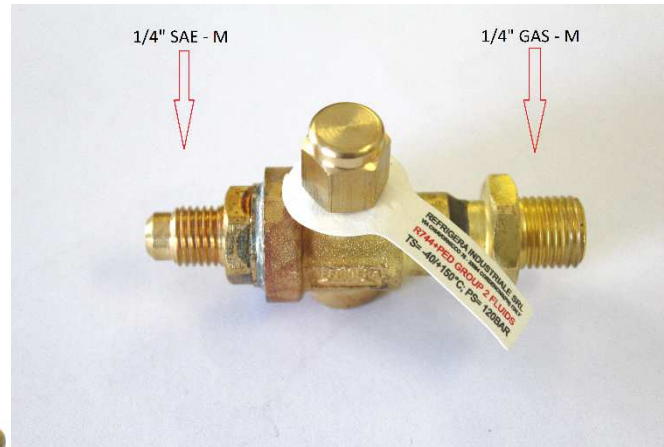

CUSTOMIZATION



Ball & Check Valve

Integrated Solution 3 in 1

- Ball Valve
- Check valve
- Flange Connection for Turbocor

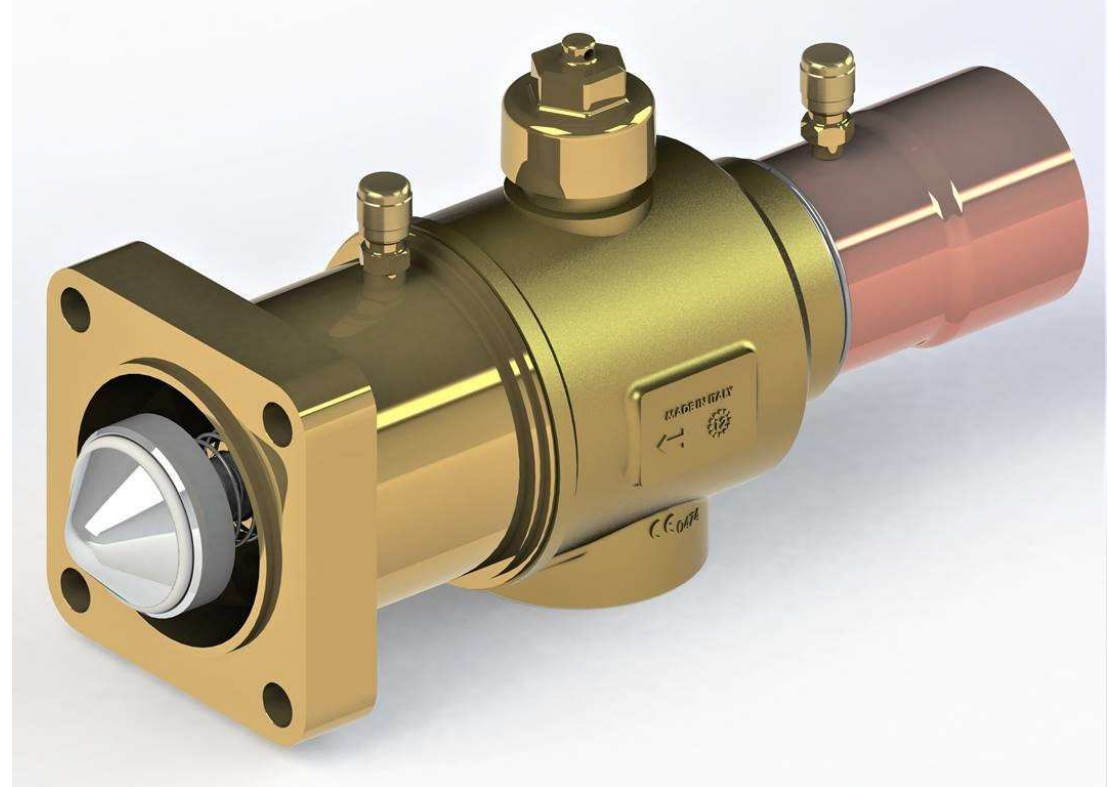

CUSTOMIZATION



Valvola V-Port

- Suitable for HFC - HC – HFO – R744
- High and Low Pressure
- Ball Valve 2 or 3 WAY
- V-PORT Angle : 30°o 60°

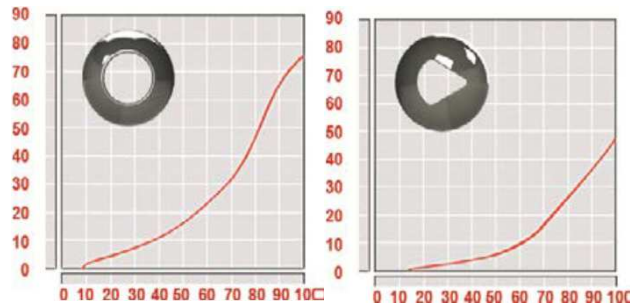

Applications:

- By-pass the gas cooler with a 3 WAY.
- Mechanical Expansion valve with a 2 WAY.

By-Pass Valve



Ball Valve + Check Valve

- Protection against Over Pressure
- Suitable for: *HFC - HFO - HC - R744*
- High and Low Pressure



Y STRAINERS

- Range: da 5/8 a 7/8 o 16mm.a 22mm.
- Range: da 1-1/8 a 1-5/8 o 28mm. a 42mm.
- Max working pressure 140BAR
- Filter:
 - Mesh 270 μ m
 - Mesh 150 μ m (On Request)

Connections available:

- No Connections
- K65
- SS
- Hybrid K65/SS

NEW PRODUCTS



3 WAY CHANGEOVER VALVE

- High and Low Pressure
- Material: Stainless Steel
- Suitable for: CO₂, NH₃, HC, HFO, HFC

SIZE:

- From 1/2 up to 1-1/4 NPT

SAFETY VALVES

With and Without Outlet Connections

3 SETTING PRESSURE RANGES:

- 0,1 - 60 BAR
- 60 - 100 BAR
- 100 - 150 BAR

- Suitable for HFC, HC, HFO, CO2...

- ATEX, ASME, CRN certifications available on request



NEW PRODUCTS



DN65 Ball Valve for CO2

Design pressure 60BAR

BRASS BODY - STAINLESS STEEL CONNECTIONS

Test pressure: 85,8BAR

NEW PRODUCTS



Multi Port Manifold

- 100% Customized
- Multiple choice of connections SAE – NPT – GAS
- High and Low Pressure
- Brass or SS Body



NEW PRODUCTS



4 WAY BALL VALVE

The 4-way Reversing Valve is the key component to provide Heating and Cooling by reversing the flow direction of refrigerant.

The quality and the design of this new component were carefully studied to guarantee safe and endurance at highest working conditions. Stainless Steel body assure high performance even in the wide range of R744 applications.

The cycle inversion needs no solenoid pilot valve and no slider movement, reducing risk of mechanical seizures.

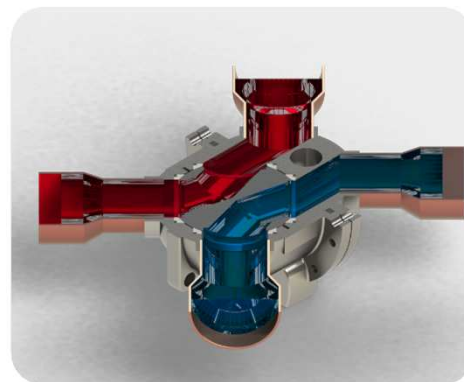
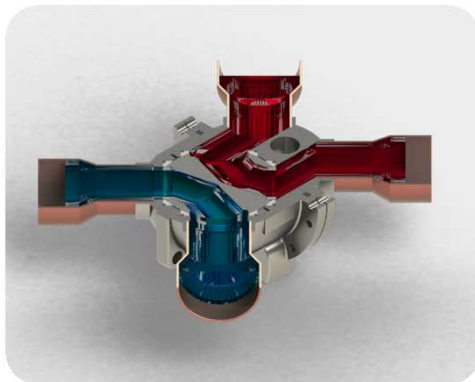

SIZE = 7/8 " up to 3 - 1/8"
PRESSURE = High and Low

Refriger Industriale S.r.l.
www.Refriger.eu

NEW PRODUCTS



Ball Valve Suitable for Ammonia NH₃

- Configuration 2 or 3 WAY
- Material Stainless Steel
- Motorized version Available

NEW PRODUCTS



Valves with Straight Connections

- Straight tails
- Suitable for the most common Braze-Free connections
- Working pressure 52BAR (Ball Valve)

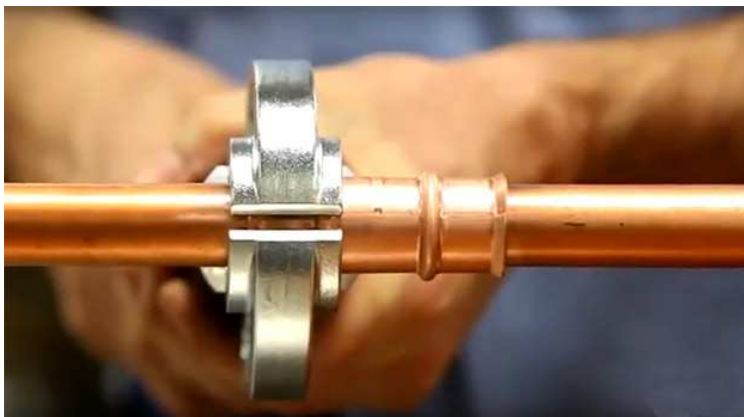



Insulating Sleeve for Ball Valves

- Refrigera insulating Sleeve are made with Fire Proof material in compliance even with the  certification.
- They can be used with the most frequently sold valves.



RECENT PRODUCT

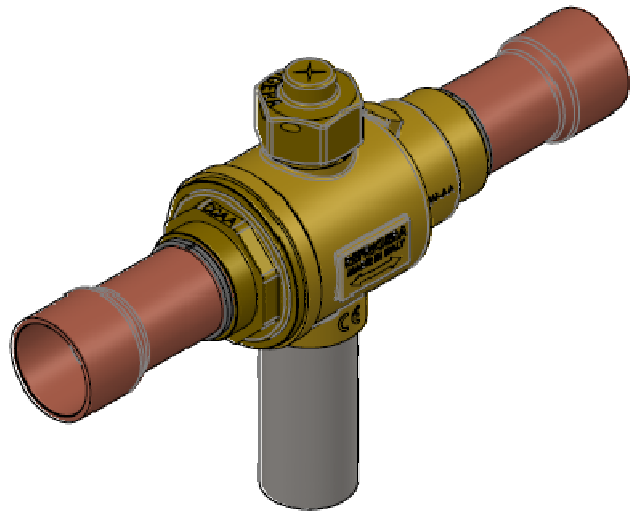

Hybrid Connections

- Valve with hybrid connections K65 – Stainless Steel
- From size 3/8 or 10mm. To 1-5/8 or 42mm.



CONNECTION KIT UPGRADE VERSION



New Connections Kits made in Stainless Steel are ready as an alternative of the standard ones, possible application fields:

- Overseas, where the environment brought more aggressive agents.
- Where the valves are placed in high humidity areas
- With NH₃ applications
- If placed outside (recommended)

The BOSS: DN50 130BAR



Stainless Steel : DN50

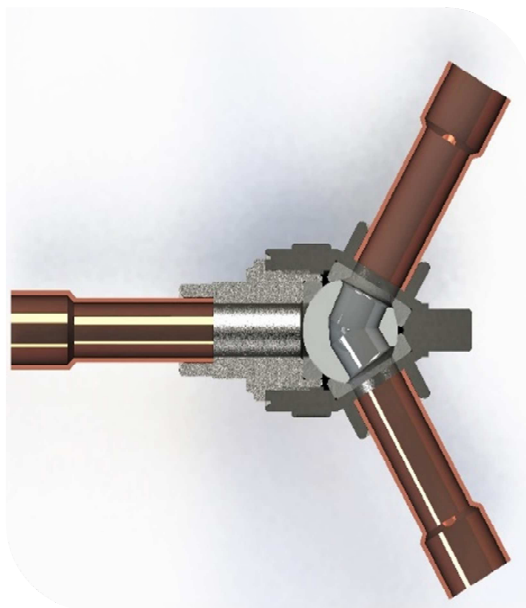

3 WAY - Y MULTIFUNCTIONAL VALVE

- High Differential pressure Handlable between the close and the open side.
- 1 Additional working WAY
- No Fluid MIX during ball rotation.





See you in our new Premises